

# Cohort Tracking: Grade Distribution

## Description:

This report allows faculty to track the performance of their students in subsequent courses. For example, faculty could see how students who took MAT0020 from them in 20051 (the cohort to be tracked) subsequently performed in MAT1033. Faculty will only be able to track students in their own classes.

## Instructions:

When you open the report, you will see the screen below:

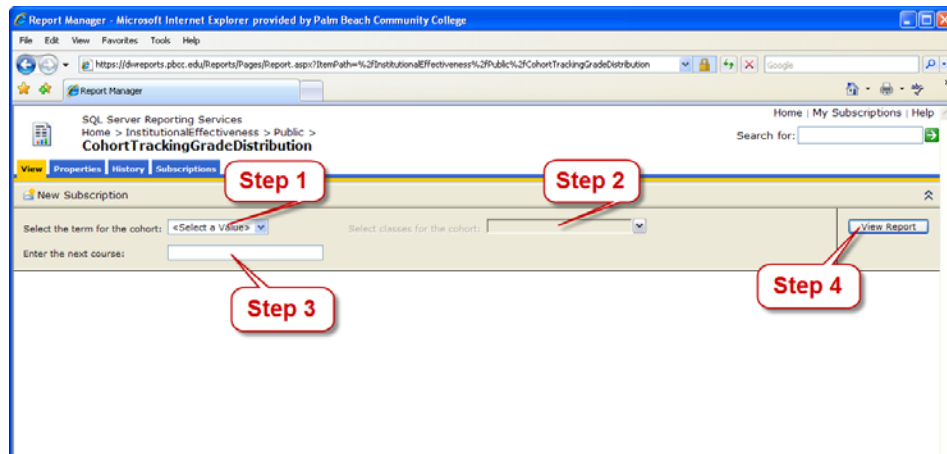

1. To begin, just select the term in which you taught the students you want to track.

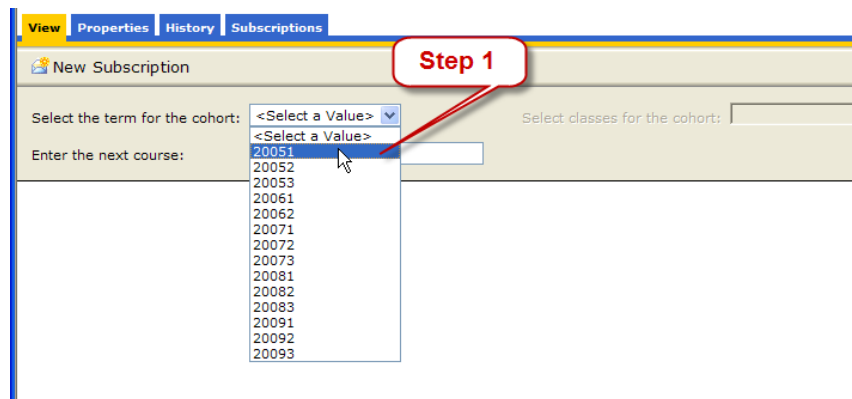

- You will then be shown a list of the classes you taught in that term. Select one or more sections that comprise the cohort you wish to track.

- Finally enter the course number of the subsequent course for which you want to see their grades.

- Click the "View Report" on the right side of the page.

The report generated will exhibit those grades for every subsequent term in which at least one member of the cohort attempted this class for the first time (multiple attempts are not displayed).

5. To save a copy of the report, select a format from the list of choices and then click “Export”.

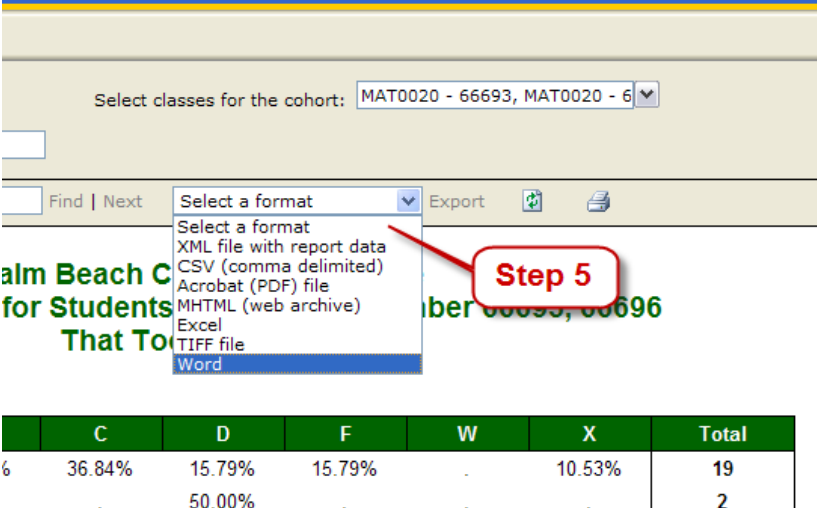

Select classes for the cohort: MAT0020 - 66693, MAT0020 - 6

Find | Next Select a format Export

Select a format

- Select a format
- XML file with report data
- CSV (comma delimited)
- Acrobat (PDF) file
- MHTML (web archive)
- Excel
- TIFF file
- Word

**Step 5**

	C	D	F	W	X	Total
6	36.84%	15.79%	15.79%	.	10.53%	19
		50.00%	.	.	.	2

You may select a different cohort or subsequent course for the current cohort by changing one or more of the parameters and then clicking “View Report” again.